



GOSSOUTDOOR

shading systems

Eivissa  
Ordering  
Guide

ETHIMO

# Step by Step Guide to Ordering Your GOSS Outdoor Eivissa Pavilion



You can make sure you have chosen the right product and optional items from the available options outlined in the rest of the document.



Get in contact with one of our team members with this information for a price quotation by emailing [contact@gossoutdoor.co.uk](mailto:contact@gossoutdoor.co.uk) or calling **0800 689 4549**.



**Note:** It is the responsibility of the customer to check whether **planning permission** is required. Seek professional advice, speak to your local planning authority or contact your operator.



Once you receive a quotation, inform our team that you would like to make an order. They will prepare a special order form which you can take to your local **COSTCO** branch to make a payment. Complete your order by following the instructions on the special order form.



The **GOSS Outdoor** team will arrange a site survey to check the site for installation and will confirm all final details with you such as measurements, colours and technical details. You can choose from our **swatch samples** during our site survey.



Enjoy your Eivissa pavilion and making use of your outdoor space in all weather conditions!



As part of our **2-year warranty**, we will visit your Eivissa as required and carry out checks. During this period we provide free servicing of your Eivissa.



Your Eivissa pavilion will be installed either on the date of delivery or soon after depending on weather conditions.



Your Eivissa pavilion will be delivered at a date previously arranged.



The **GOSS Outdoor** team will keep you updated with every stage of your order, including delivery and installation from this point on.



Prior to delivery or installation please make sure you have read **The Preparation Guide** on page 7 of this document and all requirements have been carried out.

# Choosing Your Product



1



Choosing Your Size | [Page 3](#)

2



Choosing Your Base | [Page 3](#)

3



Choosing Your System Type | [Page 4](#)

4



Choosing Your Complimentary Elements | [Page 5](#)

5



Choosing Your Colours | [Page 6](#)

## STEP 1 | Choosing Your Size

- Eivissa cannot be produced in custom measurements.  
There are three standard sizes available for the Eivissa Pavilion:



**375x375cm**  
height:244cm  
height with base:258cm

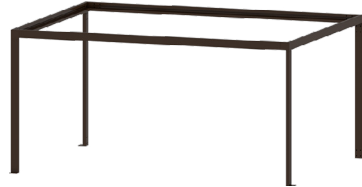

**375x495cm**  
height:244cm  
height with base:258cm



**495x495cm**  
height:244cm  
height with base:258cm

- Please measure the available width, depth and height of your site to make sure there is sufficient space to fit your preferred Eivissa.
- Make sure to leave at least 10cm clearance above the Eivissa Pavillion.

## STEP 2 | Choosing Your Base

**OPTION 1**  
No Base



**OPTION 2**  
Wood Base

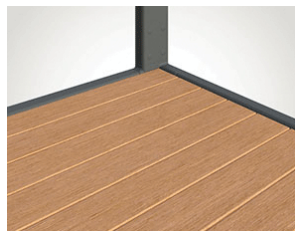

Solid Teak

**OPTION 3**  
Stone Base

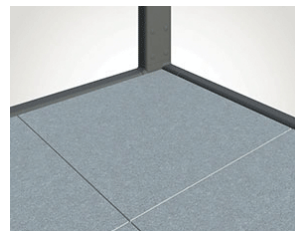

Ceramic  
Stone  
White



Ceramic  
Stone  
Grey



Ceramic  
Stone Black  
Vulcano

The Eivissa Pavilion can have either solid teak wood decking or stoneware, available in three colours.

# STEP 3 | Choosing Your System Type

## OPTION 1 | Eivissa Open Air

Pavilion without covering



### Optional Addition



Pickled Teak

### Fixed Slats

The cover with fixed teak slats responds to both aesthetic and functional needs. It allows shade to be achieved by exploiting the inclination of the teak blades and creating a pleasant passage of air.

(Only available for Eivissa Open Air)

## OPTION 2 | Eivissa Light & Proof

Pavilion with covering  
in compact polycarbonate

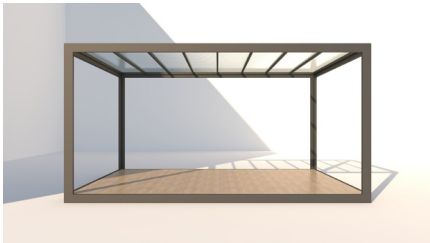

### Roof Options



Polycarbonate  
Light



Polycarbonate  
Fume

### Roof in Polycarbonate

The Light & Proof roof is made of sheets of polycarbonate 3mm thick and about 60cm wide. Each sheet has a load capacity of about 15kg/m<sup>2</sup>. The polycarbonate comes in either a clear or smokey version. The sheets slide into calendered aluminium guides that force the roof to curve, ensuring water runs off laterally into dedicated gutters and then down through the structure posts to the ground.

(Only available for Eivissa Light & Proof)

## OPTION 3 | Eivissa Climate

Pavilion with adjustable covering  
with adjustable louvres

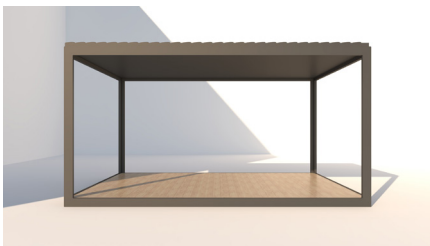

### Optional Addition

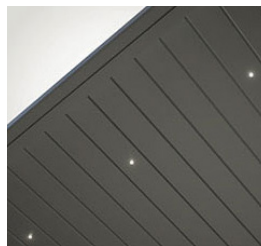

### Lighting

Climate cover can contain LED light points integrated in the slats.

(Only available for Eivissa Climate)

### Optional Item for the Roof

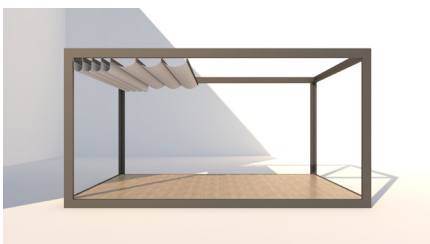

### Optional Addition



Acrylic  
Heritage Red



Acrylic  
Cappuccino



Acrylic  
Nature White



Acrylic  
Nature Grey

### Sliding Flow Curtain

Flow is a fabric curtain that provides both decoration and shade. Practical and Functional, it can be opened or closed to adjust light and shade.

(Available for all Eivissa Models)



## STEP 4 | Choosing Your Complimentary Elements (Optional)

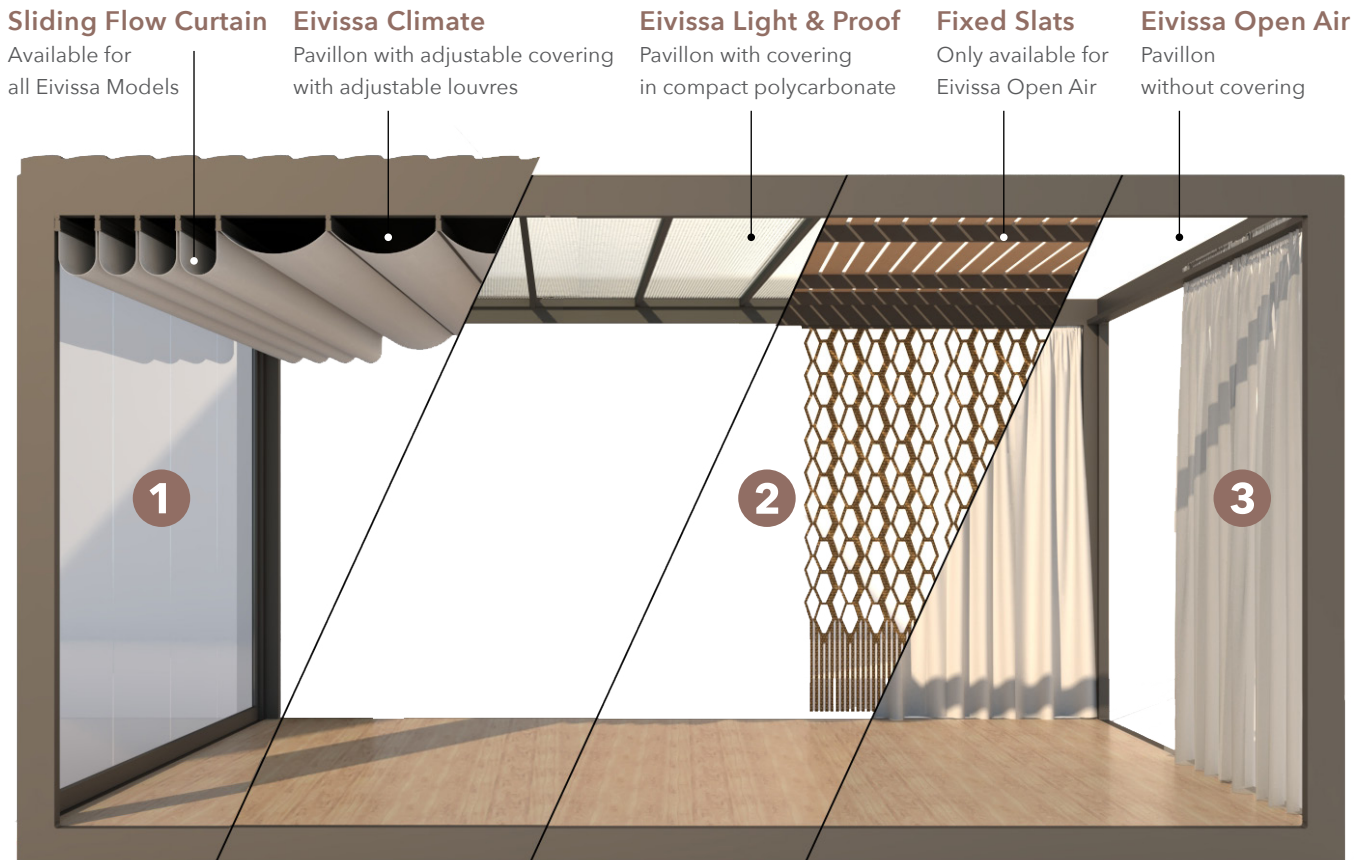

**1 Glass Panels**  
Fitted with perimeter glass panels, Eivissa becomes a completely closed space, insulated from its surroundings. The separate glass panels can be fitted to each side and fold as they open. The 375cm version requires four glass panels; the 495cm one five. Each tempered glass panels is 10mm thick and about 90cm wide. They have a built-in handle for easy opening and closing, and a foot-activated locking system. The panels can be installed both on the pavilion version with flooring and on the version fixed directly to the ground.



Tempered  
Crystal

**2 Braided Rope Curtains**  
The pavilion can be closed on each side by interwoven polypropylene curtains available in two colors. The fringes in synthetic rope take up the traditional workings of lace, creating suggestive graphic effects and plays of shadows.



Polypropylene  
Dove Grey



Polypropylene  
Light Grey

**3 Acrylic Fabric Curtains**  
The pavilion can be closed on all sides thanks to acrylic curtains available in four colours.



Acrylic  
Sand



Acrylic  
Marmot



Acrylic  
Chalk



Acrylic  
Aluminium

## STEP 5 | Choosing Your Colours

Aluminium painted in 9 colors.

**Characteristics of the slats:** aluminum, size 19 x 5 cm, snow load resistance 75 kg/sqm, water seal 10 mm/h, adjustable up to 90° with radio control.



Aluminium  
Warm White



Aluminium  
Warm Grey



Aluminium  
Warm Red

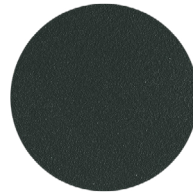

Aluminium  
Dark Grey



Aluminium  
Coffee Brown



Aluminium  
Camouflage Green

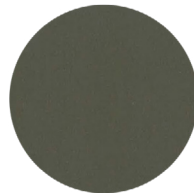

Aluminium  
Camouflage Grey



Aluminium  
Camouflage Brown



Aluminium  
Pearl Grey

Some various colour examples.

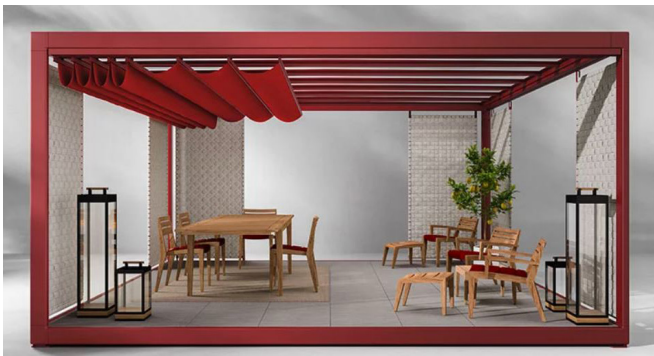



Prior to coming for installation, we would like to inform you of a few requirements to ensure a speedy and safe installation of your Eivissa pavilion. Please make sure you read this guide carefully.

---



## Allow Access & Clear the Site

To allow safe delivery you will need to make sure there is clear access of the route from the vehicle to the point of delivery. Deliveries are made to the nearest accessible point. You will need to remove all debris and ensure there are no tripping hazards on the pathways around the property. Please ensure that we are informed of any access issues i.e. restricted access, gradients, gravel driveways etc. Our team will require sufficient space around the installation site which is unique to each site and project. This will be noted by our technician during his/her survey, so please make sure you move anything that may be in the way as is instructed by our team during the survey. Any special circumstances will also be taken into consideration at this point. We kindly ask you to create a comfortable working space for our team.



## Electrical Requirements

If your Eivissa is The Eivissa Climate with a motorised adjustable louvred roof, you will need a power outlet to connect the pavilion. Please note, we would need all electrical requirements to be carried out by an electrician. We will commission roof, setting limits etc leaving tails hanging for your electrician to connect to the power supply. Once you make an order our team will send you detailed information about the electrical requirements for your Eivissa which you can pass onto your electrician. Our technician will also provide firsthand advice about this during the final site survey.





**GOSSOUTDOOR**

---

shading systems

**A.** Unit C, Canalside North,  
John Gilbert Way, Trafford Park  
Manchester M17 1UP, United Kingdom

**T.** +44 (0) 800 689 4549  
**E.** [contact@gossoutdoor.co.uk](mailto:contact@gossoutdoor.co.uk)  
**W.** [gossoutdoor.co.uk](http://gossoutdoor.co.uk)

GOSS Outdoor is a shading systems brand owned by Senol & Senol Ltd.

October 2020 V2.0